

TAKE IT WITH YOU TODAY

**IN STOCK**

TAKE IT WITH YOU TODAY

**3 LOW COST  
IN STOCK CABINETS  
TO CHOOSE FROM**

**NATURAL MAPLE**

Republic  
cabinets

CONTRACTOR GRADE

**KITCHEN  
BASES**

|     |       |
|-----|-------|
| B09 | \$101 |
| B12 | \$104 |
| B15 | \$108 |
| B18 | \$109 |
| B21 | \$121 |
| B24 | \$127 |
| B27 | \$130 |
| B30 | \$139 |
| B33 | \$148 |
| B36 | \$156 |

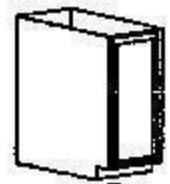

KITCHEN BASE CABINET  
HEIGHTS ARE 34 1/2" TALL

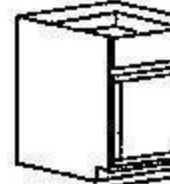

KITCHEN BASE CABINET  
DEPTHS ARE 24"

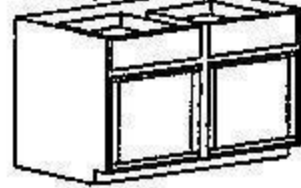

**DRAWER  
BASES**

|      |       |
|------|-------|
| DB15 | \$145 |
| DB18 | \$150 |
| DB24 | \$171 |

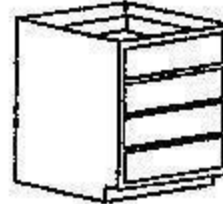

PART NUMBERS  
INDICATE  
CABINET WIDTHS

**SINK  
BASES**

|      |       |
|------|-------|
| SB30 | \$136 |
| SB33 | \$142 |
| SB36 | \$148 |

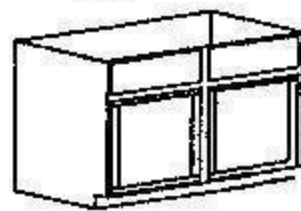

**CORNER  
BASES**

|       |       |
|-------|-------|
| LSB36 | \$224 |
| BB42  | \$161 |

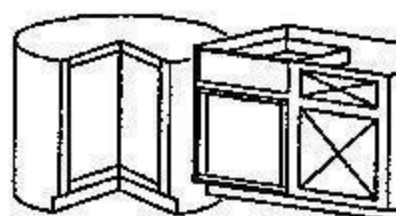

LAZY SUSAN  
BASES  
REQUIRE  
36" X 36"  
SPACE FROM  
THE INSIDE  
CORNER

**UTILITY &  
OVEN**

|          |       |
|----------|-------|
| UC188424 | \$249 |
| UC248424 | \$279 |
| OC3084   | \$388 |

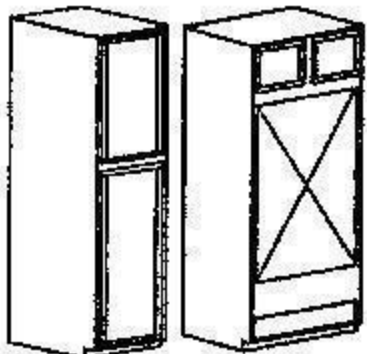

TALL CABINETS  
ARE 84" TALL  
AND 24" DEEP

**30" TALL WALL  
CABINETS**

|       |       |
|-------|-------|
| W930  | \$69  |
| W1230 | \$74  |
| W1530 | \$75  |
| W1830 | \$77  |
| W2130 | \$88  |
| W2430 | \$95  |
| W2730 | \$99  |
| W3030 | \$106 |
| W3330 | \$113 |
| W3630 | \$121 |

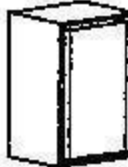

WALL CABINET  
SIZES ARE GIVEN  
IN THE PART NUMBER  
AS WIDTH X HEIGHT

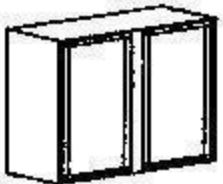

**"BRIDGE" WALL  
CABINETS**

|       |      |
|-------|------|
| W3012 | \$80 |
| W3312 | \$83 |
| W3612 | \$90 |



|       |      |
|-------|------|
| W3015 | \$80 |
| W3315 | \$83 |
| W3615 | \$90 |

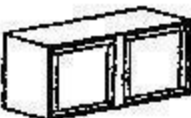

|       |      |
|-------|------|
| W3018 | \$82 |
| W3318 | \$85 |
| W3618 | \$90 |

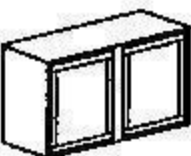

|       |      |
|-------|------|
| W3024 | \$87 |
| W3324 | \$90 |
| W3624 | \$93 |

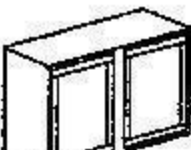

**CORNER  
WALL**

|         |       |
|---------|-------|
| WDC2430 | \$139 |
|---------|-------|

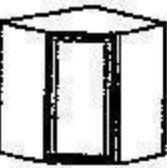

DIAGONAL WALL  
CABINETS REQUIRE  
24" X 24" SPACE  
FROM THE INSIDE  
CORNER

**FINISHED "NATURAL MAPLE"**

MAPLE RECESS FLAT PANEL WITH PICTURE FRAME DOOR  
SOLID MAPLE FACE FRAMES WITH STURDY EURO CONCEALED HINGES  
PARTICLE BOARD CASE AND DRAWERS WITH EPOXY COATED GLIDES

"IN STOCK" CABINETS ARE SUBJECT TO AVAILABILITY.  
WE BRING IN A TRUCKLOAD OF THESE CABINETS EVERY TWO WEEKS  
SO THAT IN THE EVENT OF SHORTAGES WE CAN FILL YOUR NEEDS  
QUICKLY. OTHER MAKES AND MODELS AVAILABLE WITH  
2 TO 3 WEEK LEAD TIMES.

CABINETS ARE SUBJECT TO A 25% RESTOCKING FEE IF RETURNED.  
EXCEPTIONS MUST BE ARRANGED IN WRITING.

**NATURAL MAPLE**

**VANITY  
SINK BASES**

|       |       |
|-------|-------|
| VSB24 | \$117 |
|-------|-------|

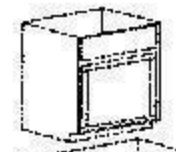

BATH VANITY  
BASE CABINET  
DEPTHS ARE 21"

|       |       |
|-------|-------|
| VSB30 | \$127 |
|-------|-------|



PART NUMBERS  
INDICATE  
CABINET WIDTHS

|       |       |
|-------|-------|
| VSC36 | \$156 |
|-------|-------|



|       |       |
|-------|-------|
| VSC48 | \$176 |
|-------|-------|

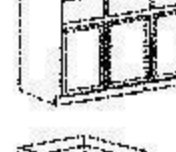

**VANITY DRAWER  
BASES & LINEN**

|       |       |
|-------|-------|
| VDB12 | \$132 |
|-------|-------|



BATH VANITY  
BASE CABINET  
HEIGHTS ARE 32.5"

|       |       |
|-------|-------|
| VDB15 | \$134 |
|-------|-------|

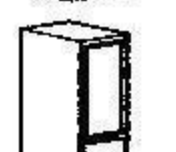

|       |       |
|-------|-------|
| VDB18 | \$135 |
|-------|-------|



LINEN CABINETS  
ARE 84" TALL  
AND 21" DEEP

|           |       |
|-----------|-------|
| LHC188421 | \$273 |
|-----------|-------|

**SINK  
FRONTS**

|       |      |
|-------|------|
| SFD36 | \$97 |
|-------|------|

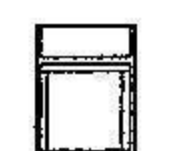

DIAGONAL SINK  
FRONTS 36" & 42"  
WIDE. SINK BOTTOM  
48"X48"

|       |       |
|-------|-------|
| SFD42 | \$105 |
|-------|-------|

**CABINET  
ACCESSORIES**

|     |      |
|-----|------|
| TKO | \$20 |
|-----|------|

|       |      |
|-------|------|
| DWEP3 | \$36 |
|-------|------|

|      |      |
|------|------|
| F330 | \$10 |
|------|------|

|      |      |
|------|------|
| F630 | \$20 |
|------|------|



Home Clearance Center

"The place for kitchen cabinets"

3313 35<sup>th</sup> Avenue  
Evans, CO 80620  
(970) 515-6270